

technische Änderungen vorbehalten

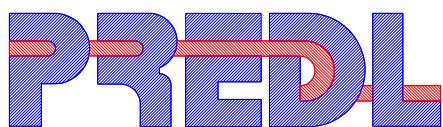

**PREDL®-Pumpschacht
DN 1000**

TYP 1

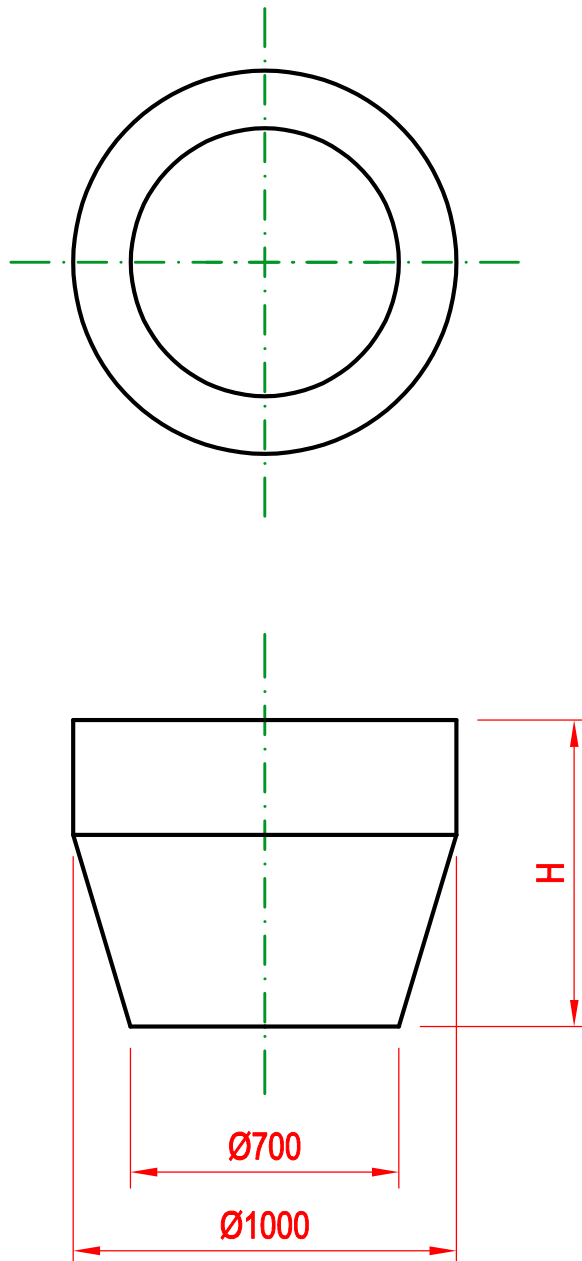

technische Änderungen vorbehalten

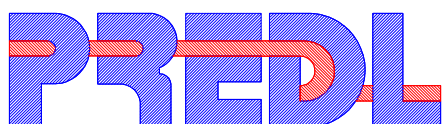

**PREDL®-Pumpschacht
DN 1000**

TYP 1-A
mit vertikaler Auskleidung

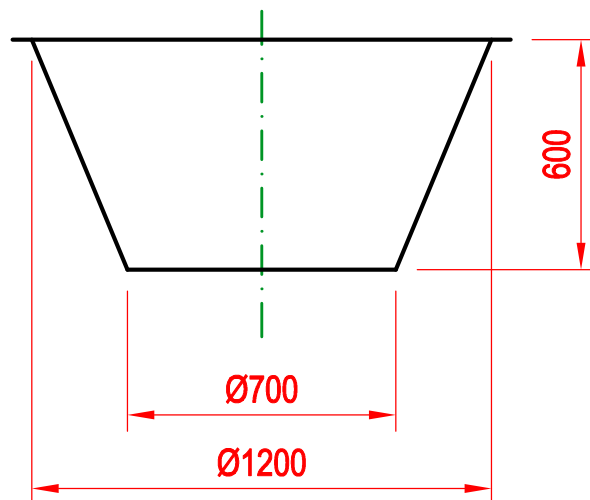
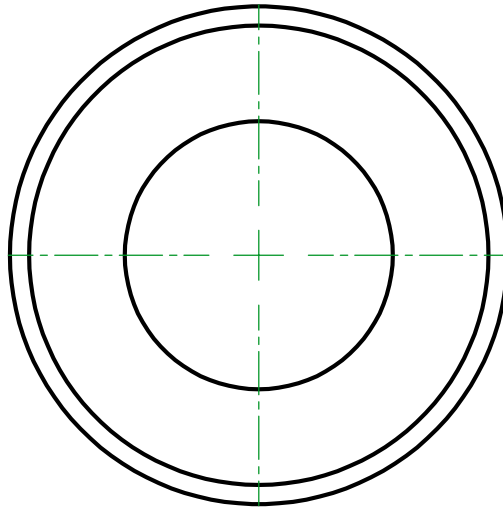

technische Änderungen vorbehalten

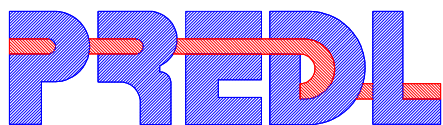

**PREDL[®]-Pumpschacht
DN 1200**

TYP 2

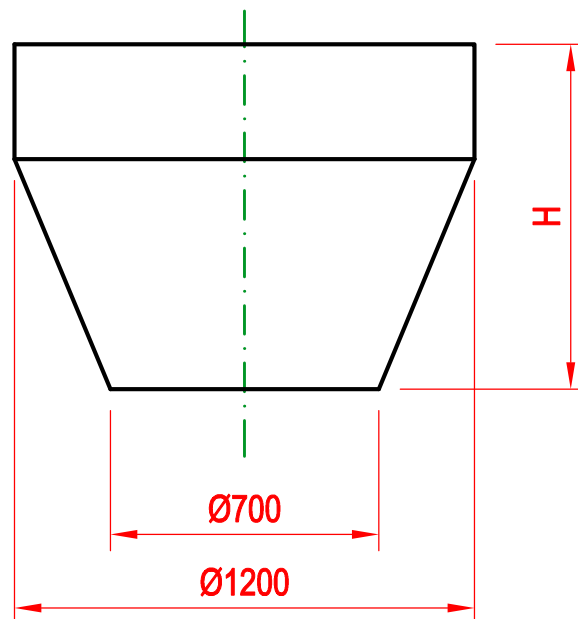
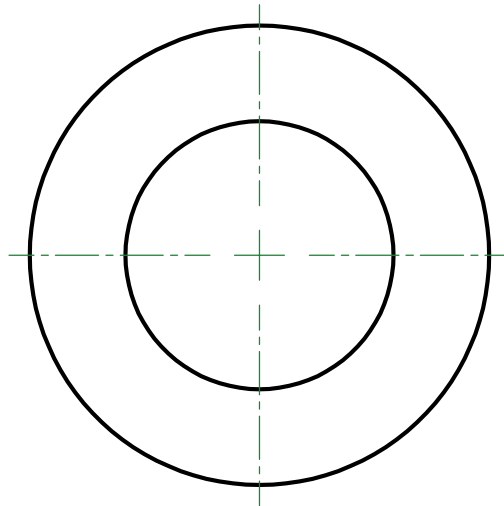

technische Änderungen vorbehalten

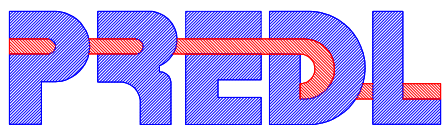

**PREDL®-Pumpschacht
DN 1200**

TYP 2-A
mit vertikaler Auskleidung

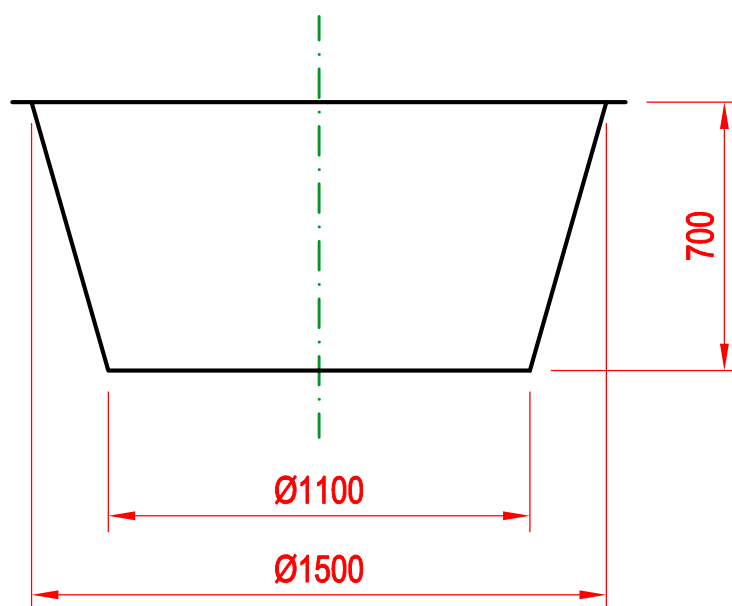
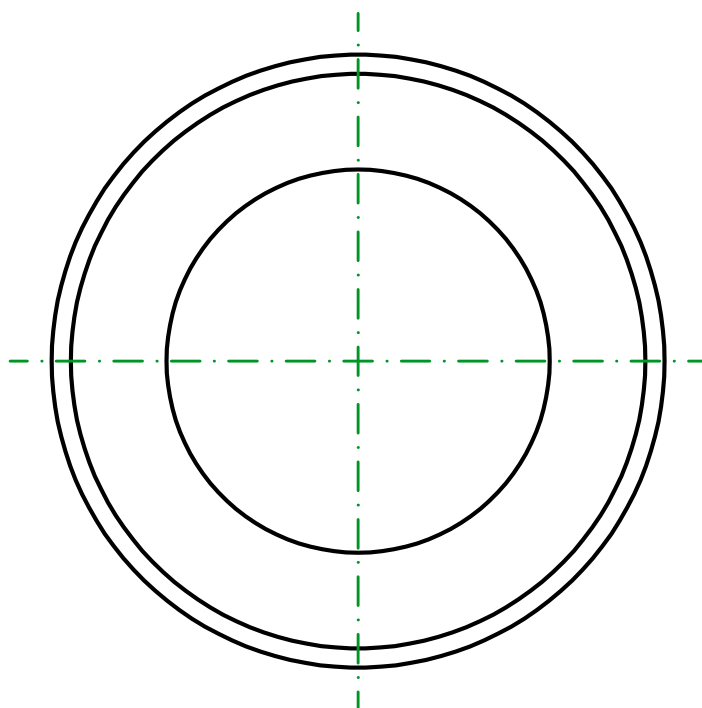

technische Änderungen vorbehalten

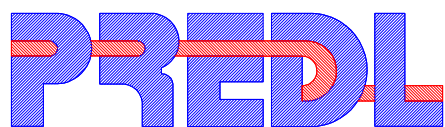

**PREDL[®]-Pumpschacht
DN 1500**

TYP 3

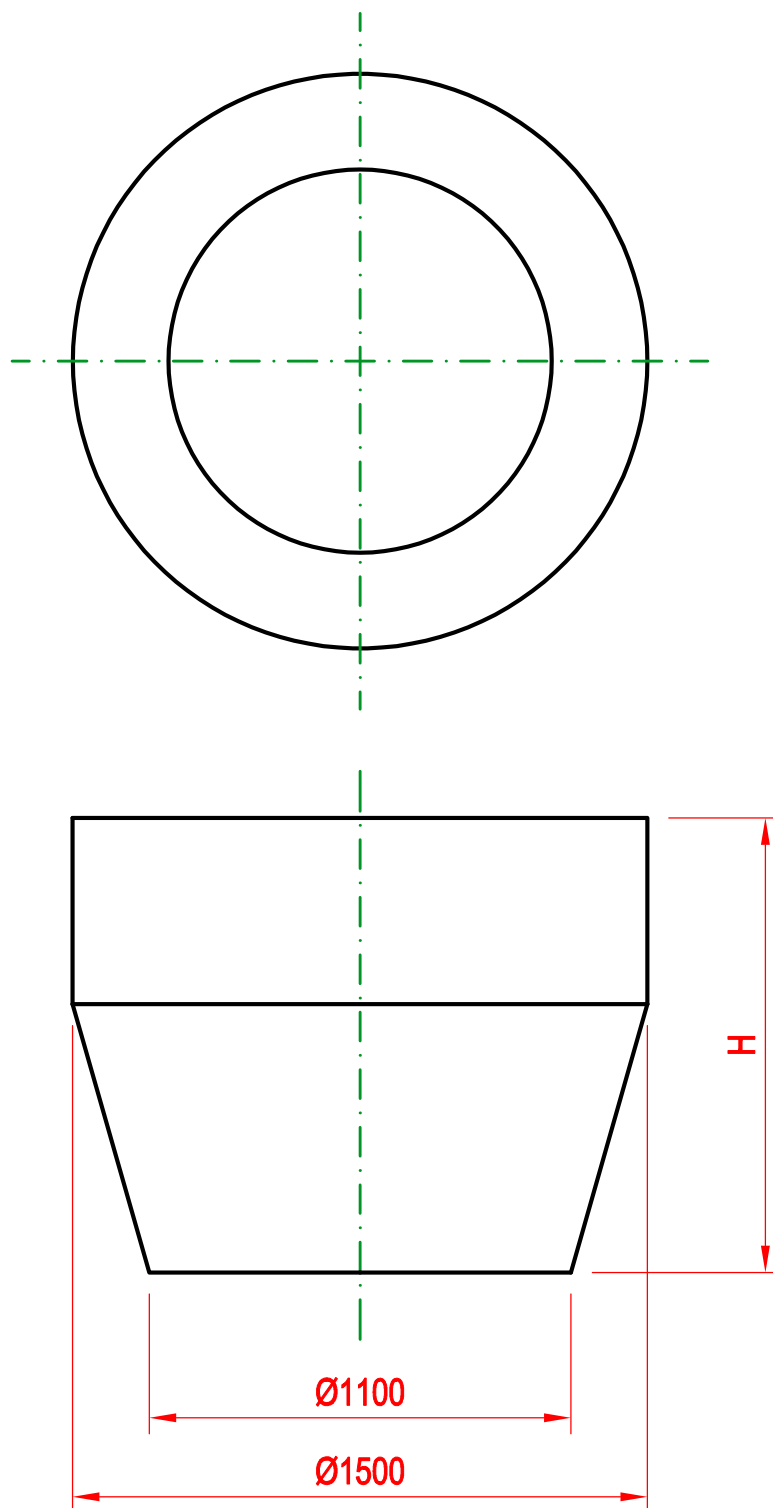

technische Änderungen vorbehalten

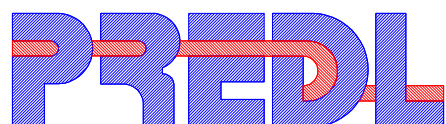

**PREDL®-Pumpschacht
DN 1500**

TYP 3-A
mit vertikaler Auskleidung

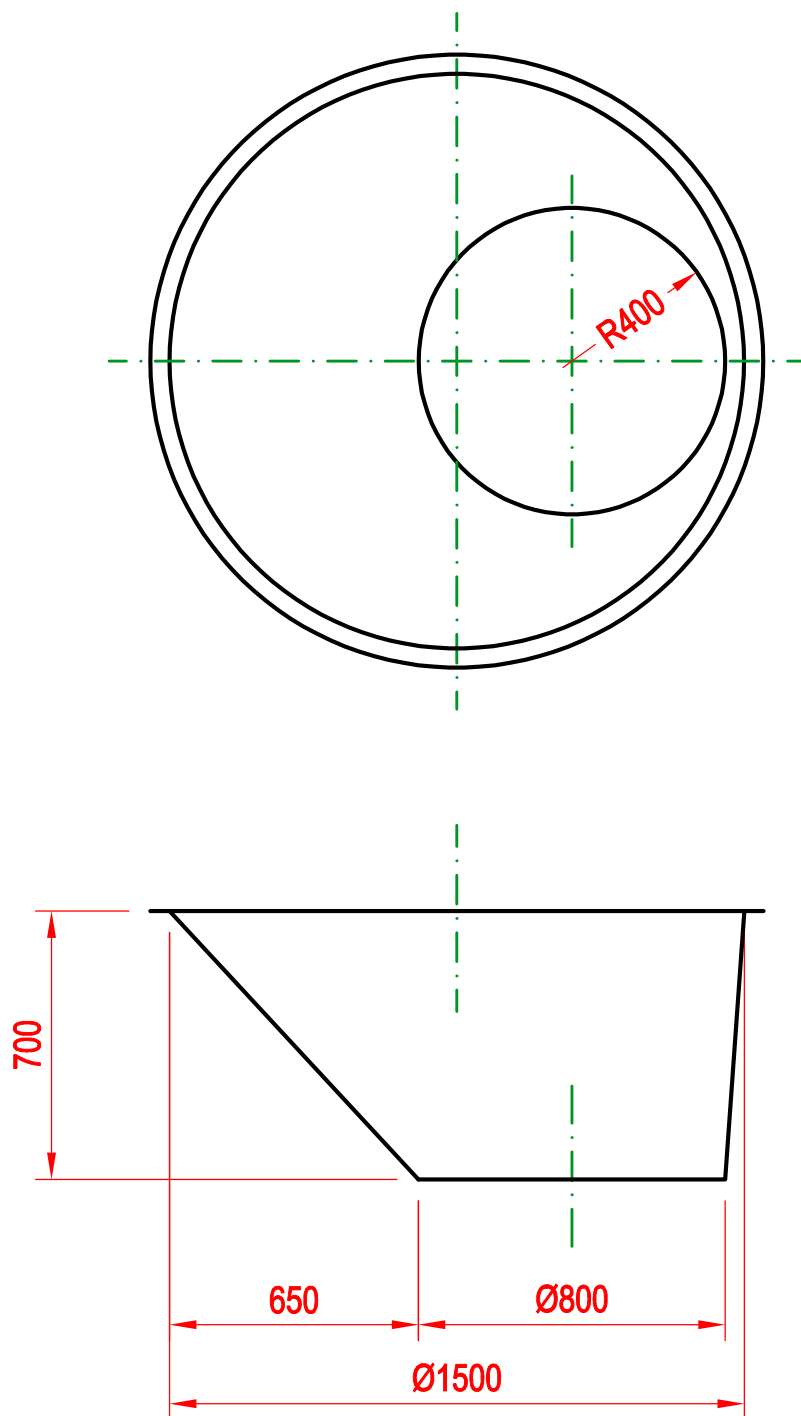

technische Änderungen vorbehalten

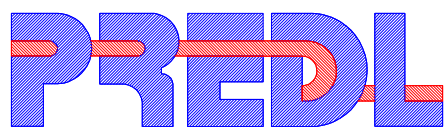

**PREDL®-Pumpschacht
DN 1500**

TYP 4

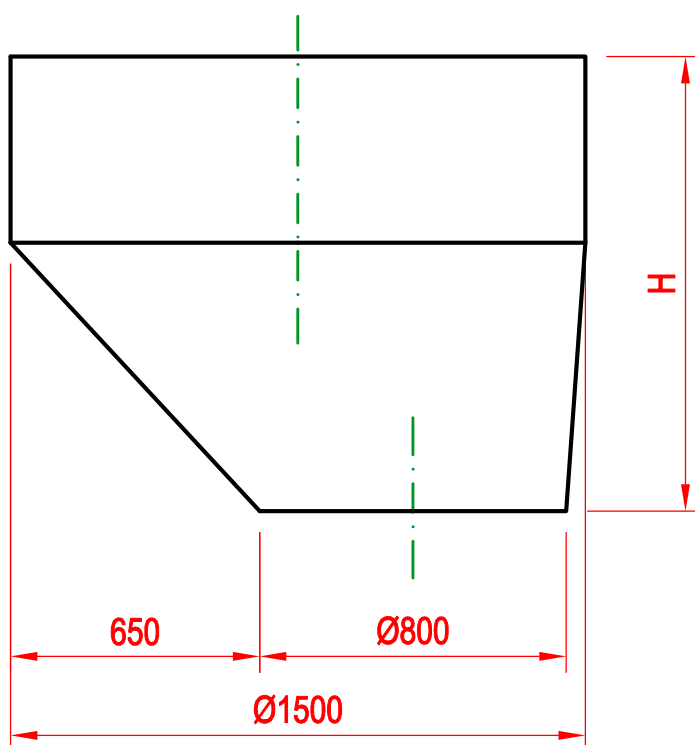
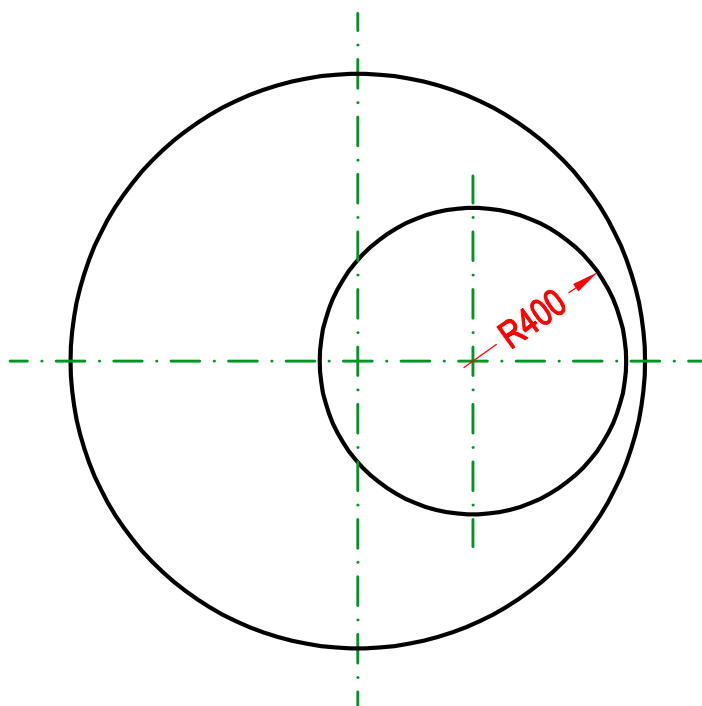

technische Änderungen vorbehalten

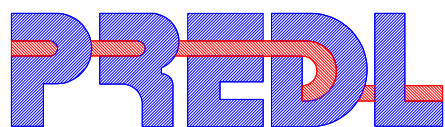

**PREDL®-Pumpschacht
DN 1500**

TYP 4-A
mit vertikaler Auskleidung

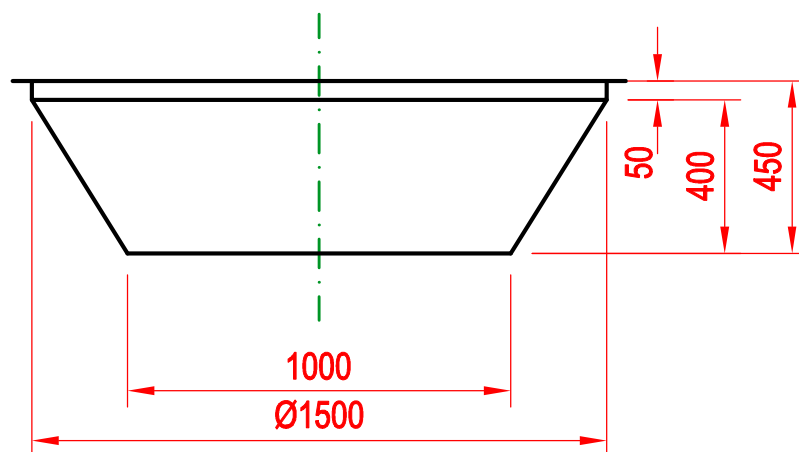
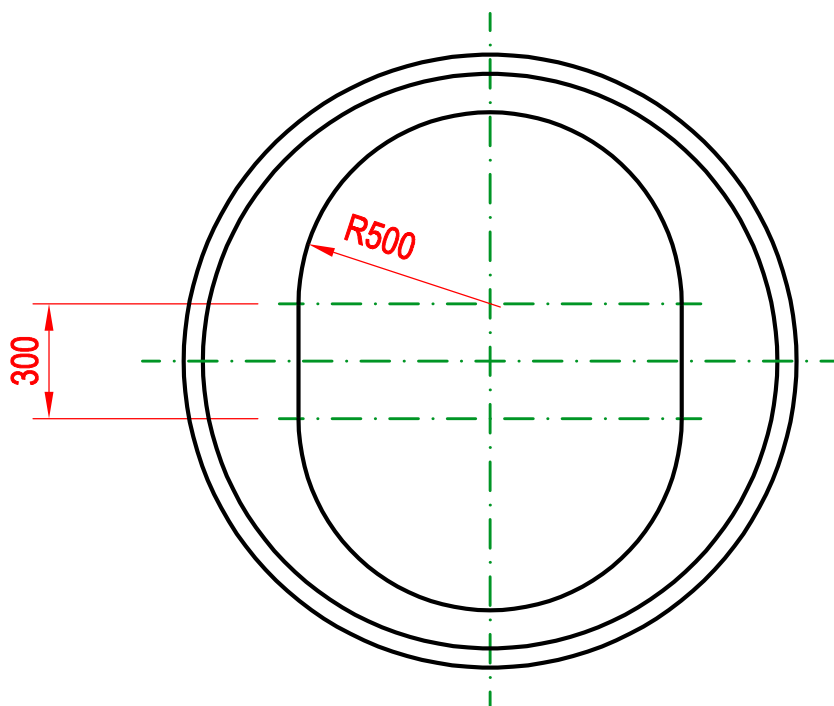

technische Änderungen vorbehalten

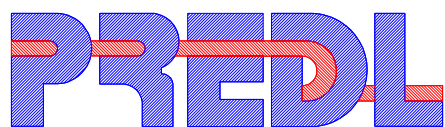

**PREDL®-Pumpschacht
DN 1500**

TYP 5

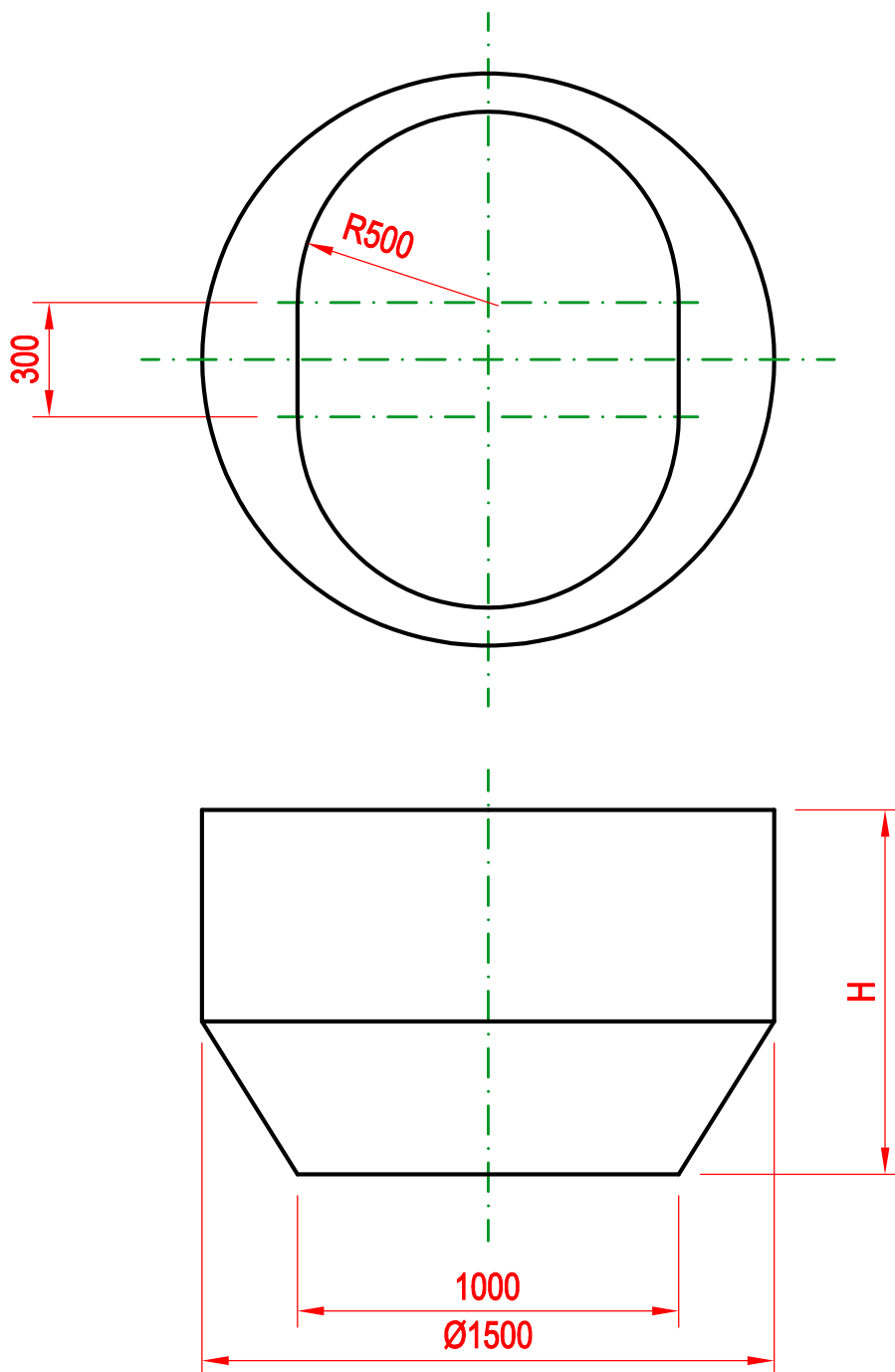

technische Änderungen vorbehalten

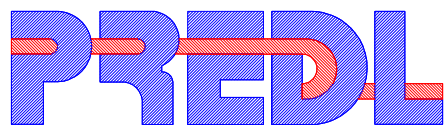

**PREDL®-Pumpschacht
DN 1500**

TYP 5-A
mit vertikaler Auskleidung

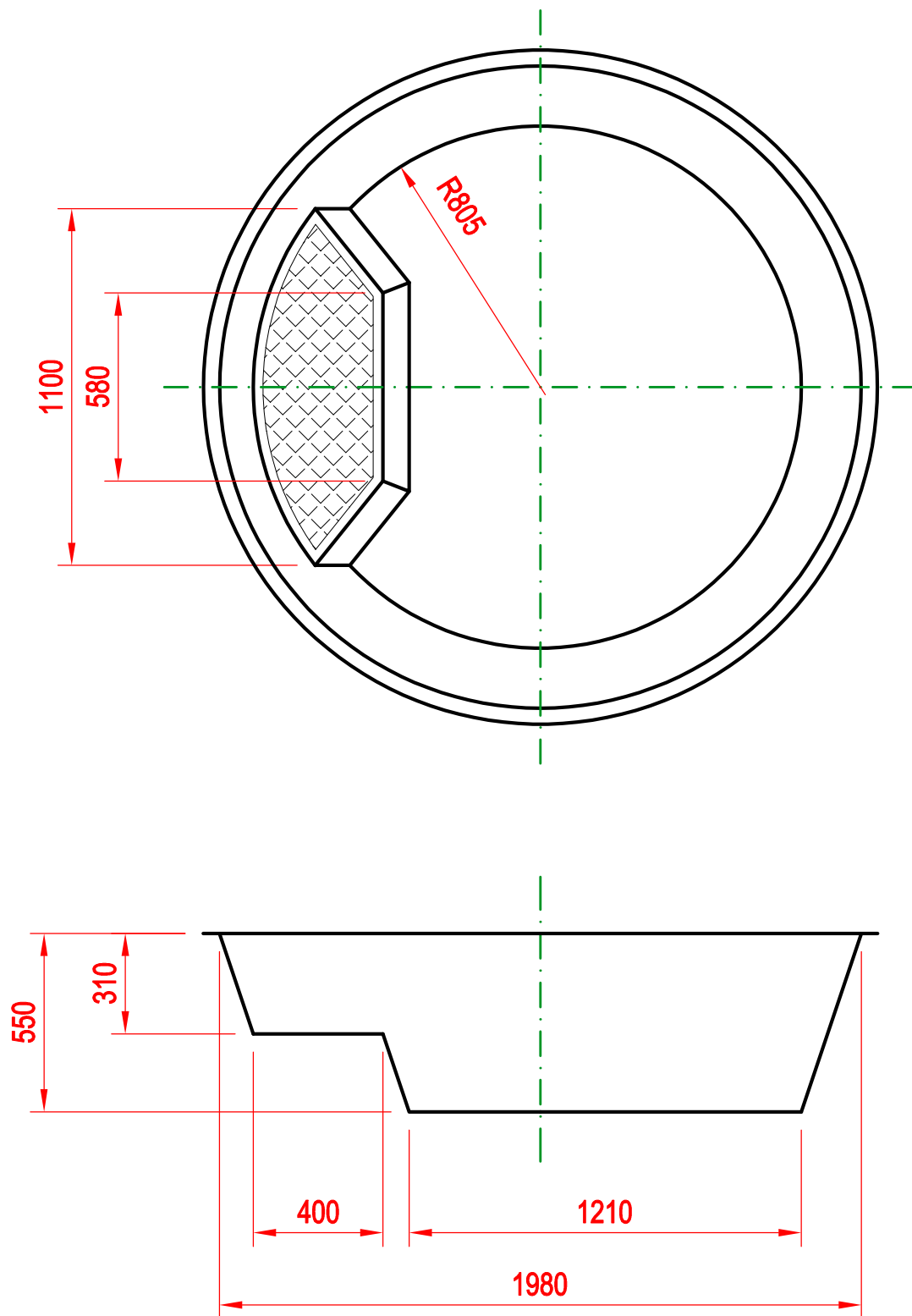

technische Änderungen vorbehalten

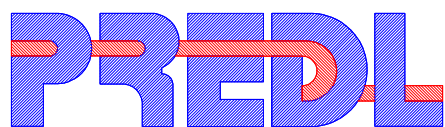

**PREDL®-Pumpschacht
DN 2000**

TYP 6

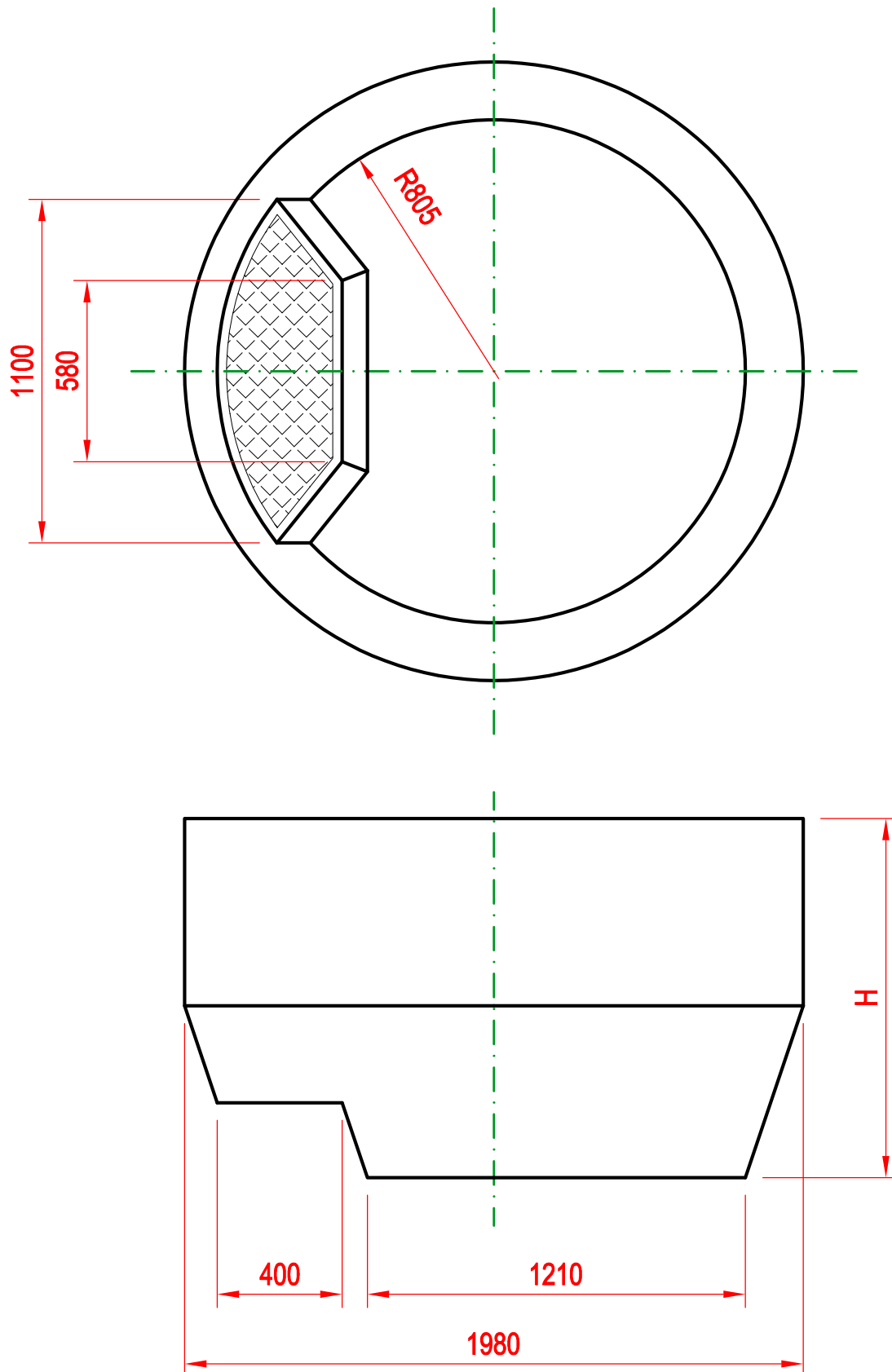

technische Änderungen vorbehalten

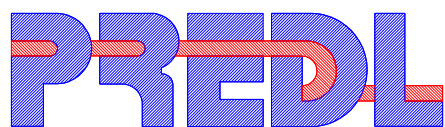

**PREDL®-Pumpschacht
DN 2000**

TYP 6-A
mit vertikaler Auskleidung

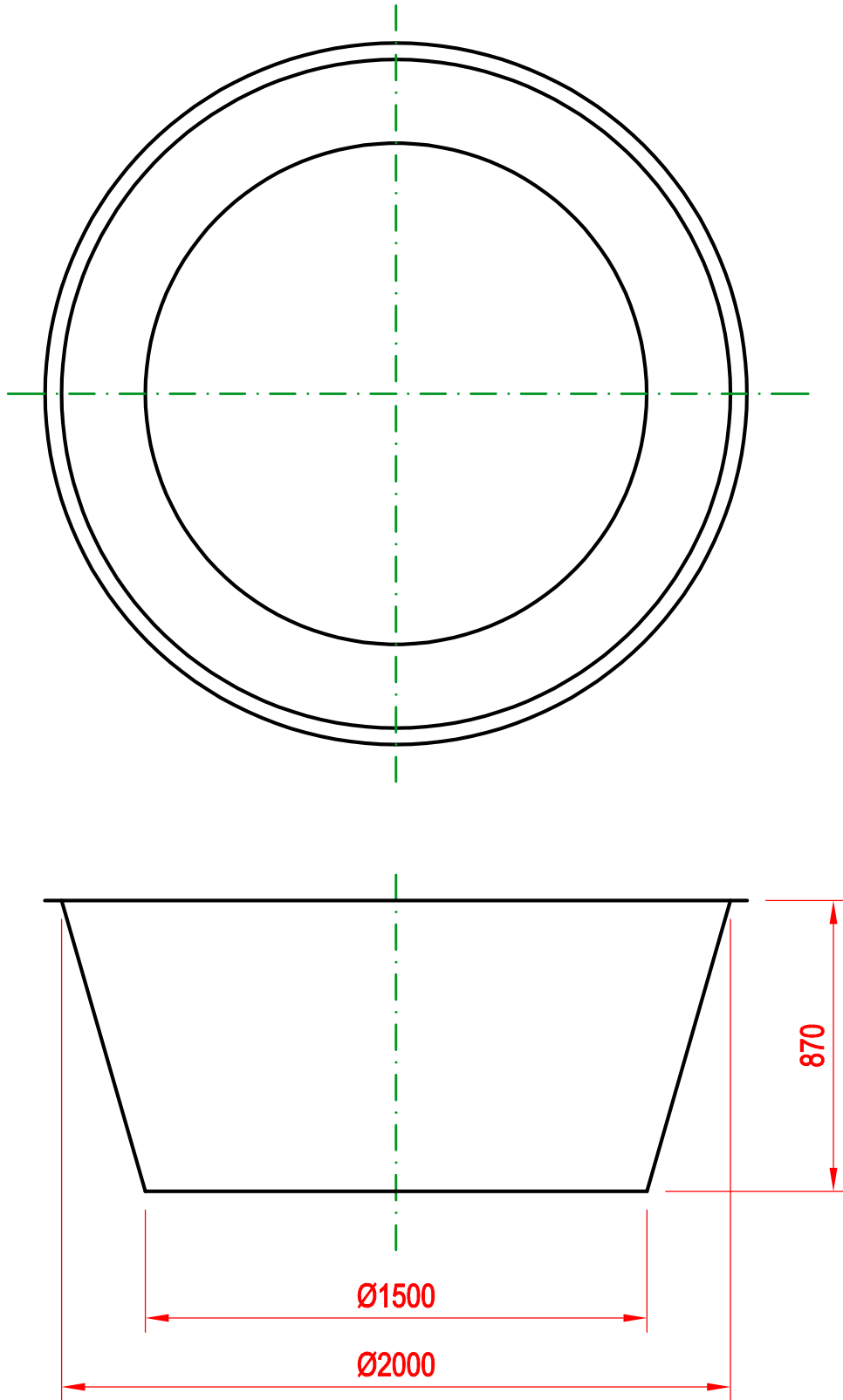

technische Änderungen vorbehalten

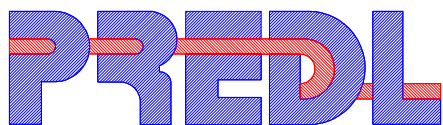

**PREDL®-Pumpschacht
DN 2000**

TYP 7

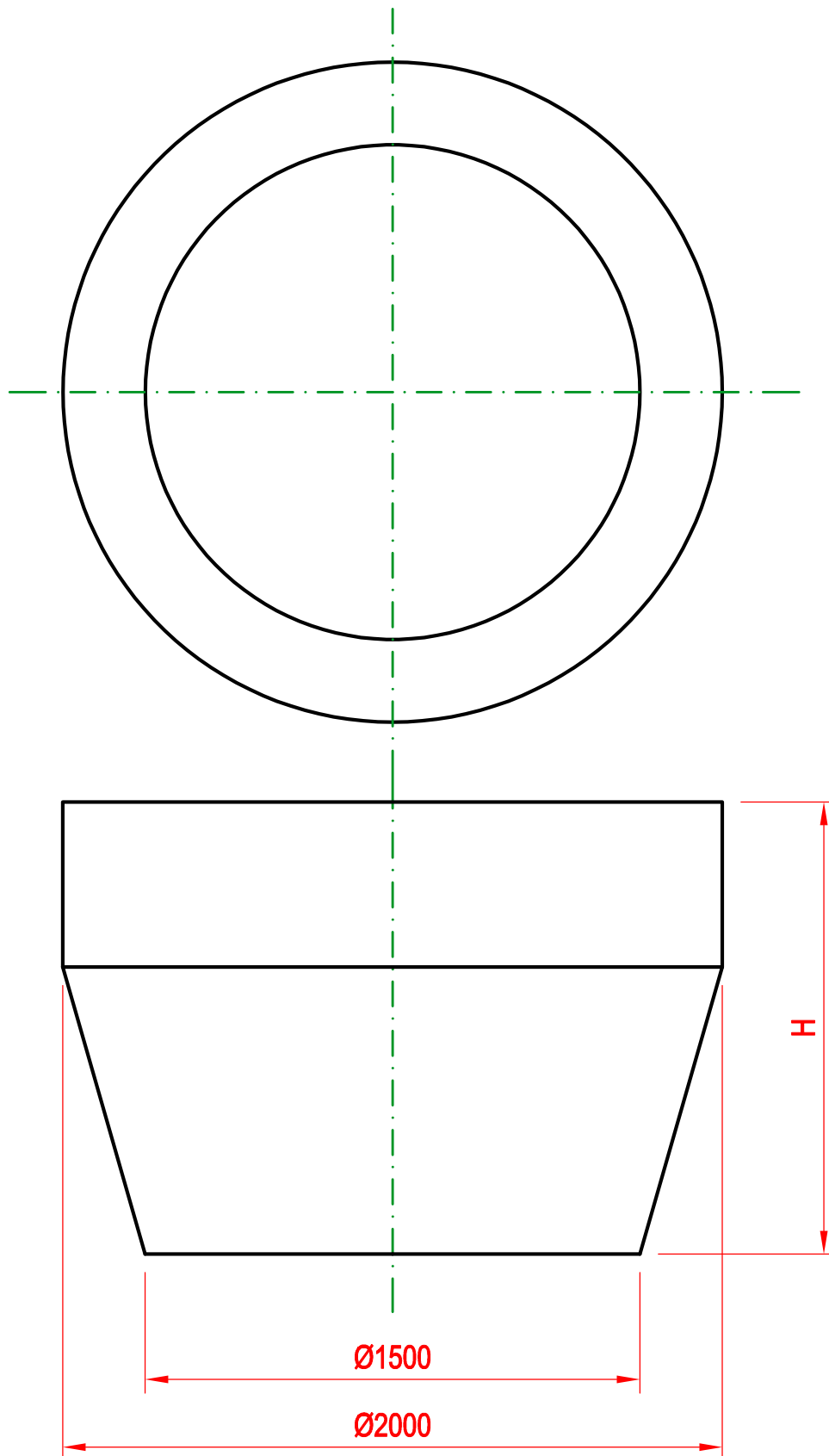

technische Änderungen vorbehalten

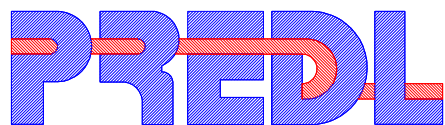

**PREDL®-Pumpschacht
DN 2000**

TYP 7-A
mit vertikaler Auskleidung

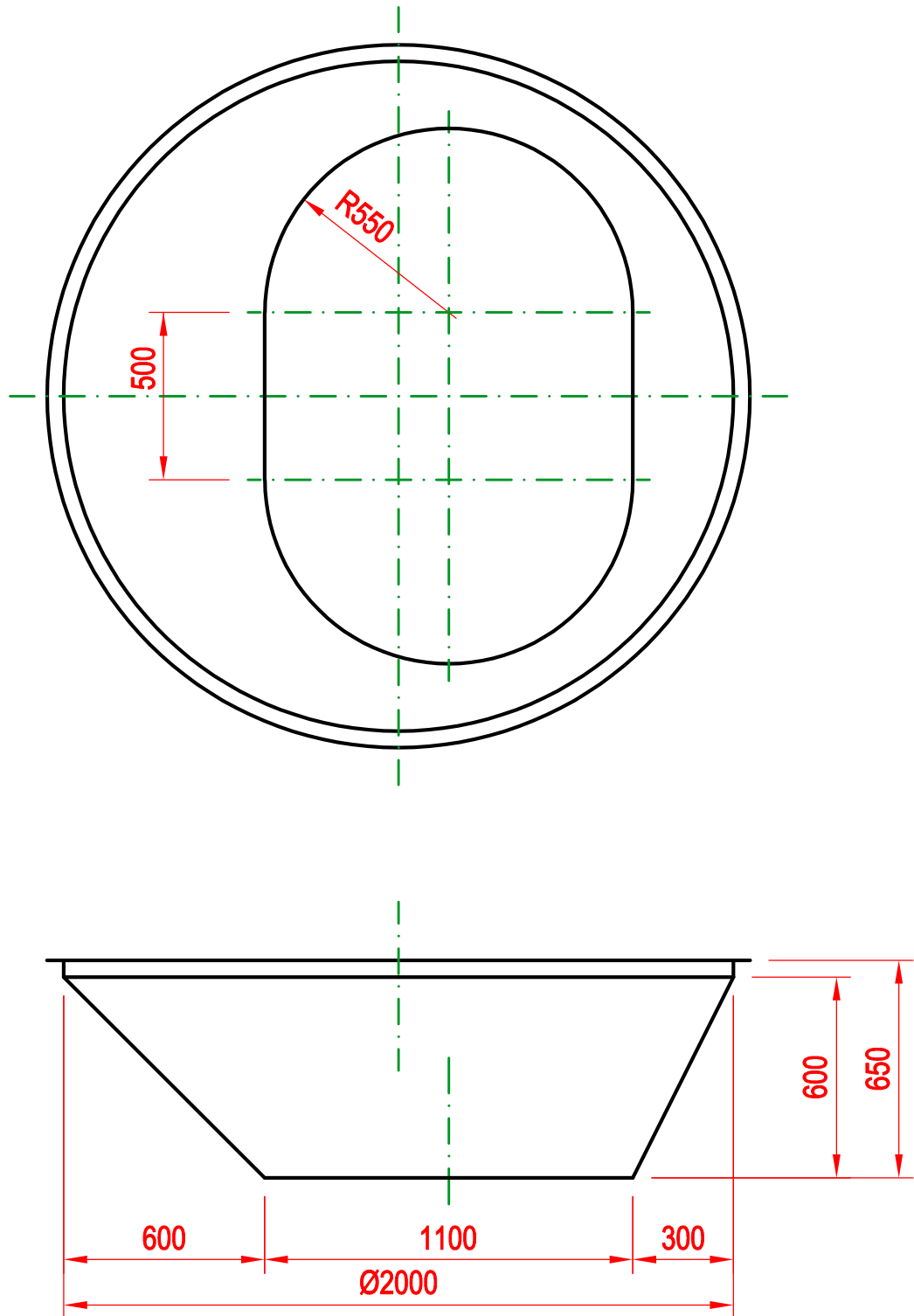

technische Änderungen vorbehalten

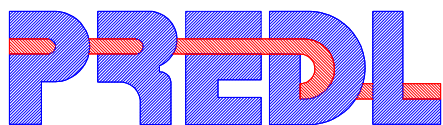

**PREDL®-Pumpschacht
DN 2000**

TYP 8

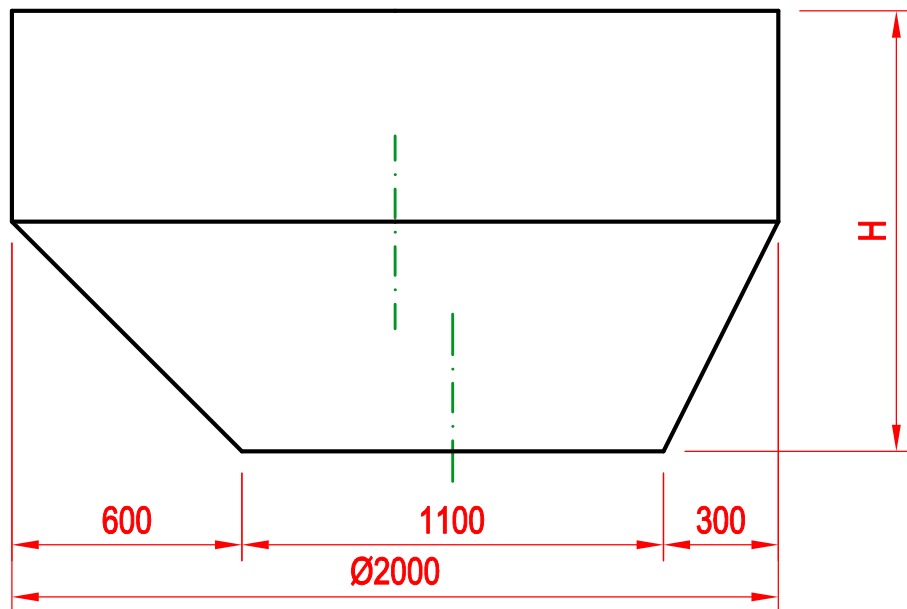
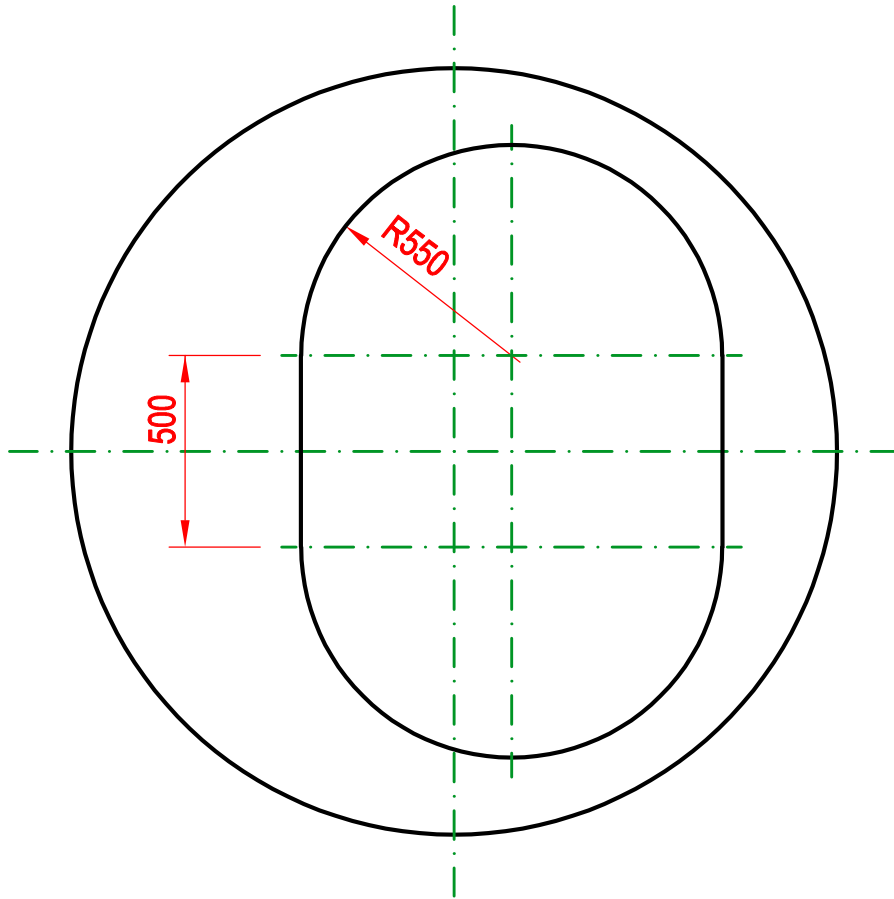

technische Änderungen vorbehalten

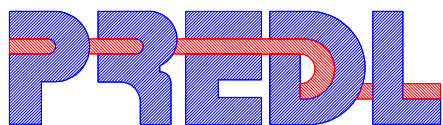

**PREDL®-Pumpschacht
DN 2000**

TYP 8-A
mit vertikaler Auskleidung